

# 2I385HW

Pico-ITX SBC supports Intel® Bay Trail Atom / Celeron CPU  
VGA, LVDS, eDP, Touch, 2 x Intel Gb Ethernet  
4DI / 4DO, 5 x USB, 4 x COM, 2 x Mini PCIe

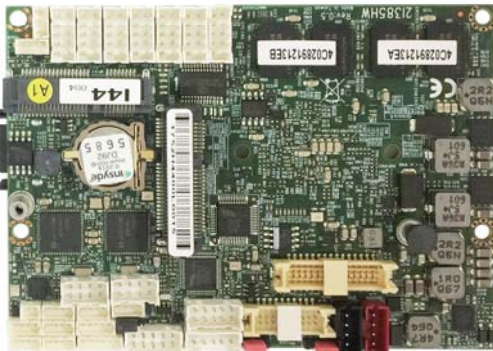

## Features:

- Intel® Bay Trail-H Atom™ E3825 1.33GHz (Dual Core)  
Intel® Bay Trail-H Atom™ E3845 1.91 GHz (Quad Core)  
Intel® Bay Trail-D Celeron® J1900 2.0GHz (Quad Core)
- On Board DDR3L 1066/1333 MHz 2GB / 4GB
- Multiple Independent display: VGA, eDP & LVDS
- 2 x Intel GbE LAN, 1 x USB 3.0, 4 x USB 2.0
- 4 x COM, 4DI / 4DO, 2 x Mini PCIe

## Dimensions: (Unit:mm)

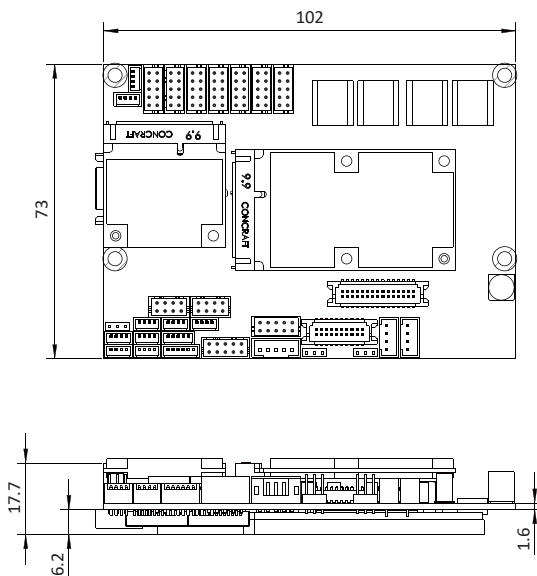

## Specifications :

- CPU  
Intel® Bay Trail-H Atom™ E3825 1.33GHz (Dual Core)  
Intel® Bay Trail-H Atom™ E3845 1.91 GHz (Quad Core)  
Intel® Bay Trail-D Celeron® J1900 2.0GHz (Quad Core)
- MB Chipset  
Intel® Bay Trail SoC
- Graphics  
Intel Gen7 graphic engine  
DirectX11, OpenGL3.2, OpenCL1.1 ; Full HW acceleration,  
decode: H.264, MPEG 2 / 4, VC-1, WMV9. Encode: H.264, MPEG2
- System Memory  
On Board DDR3L 1066 / 1333 MHz 2GB / 4GB
- Storage  
1 x SATA ports 2.0 Data transfer rates up to 3.0 Gb/s (300 MB/s), Share with mSATA 1  
2 x mini card socket for mSATA
- BIOS  
Insyde UEFI BIOS
- Display  
1 x VGA, eDP, Dual Channel, 48 bits LVDS
- Touch  
COM touch screen controller
- LAN  
2 x Intel GbE I211AT (internal)
- Audio (OEM)  
High Definition Audio Specification, Support Line-out / Mic-in / Line-in  
Two channel Class D Audio Amplifier
- Expansion Interface  
1 x Full size Mini PCIe (PCIe / mSATA / USB)  
1 x Half size Mini PCIe (mSATA / USB)

### Expansion Module

Mini Card GPS, 3G / 4G, WI-FI, 2 / 4 x LAN, 4 x COM, CANBus, SDI / AHD Video

By Cable Bluetooth, Digital I/O, 2 / 4 PoE, 4 x USB mini card

- USB  
1 x USB 3.0 (internal), 4 x USB 2.0 (internal)
- Serial IO  
4 x RS232 (internal) optional to RS485
- GPIO  
Hardware digital Input & Output, 4 x DI / 4 x DO
- WDT  
Hardware Watch Dog Timer, 0~255 sec programmable
- PS2 KB / MS  
PS2 KB / MS
- Power Input  
Wide Range +9~36V
- Dimension  
Pico-ITX 2.5" (102 x 73 mm)
- Operation Temperature  
-20°C~70°C (100 % CPU Usage)
- Operation Humidity  
5~95%, non-condensing
- Chassis (OEM I/O Expansion by request)  
IP66 / 67 waterproof Box PC, IP66 / IP67 / 69K waterproof PPC
- OS Support  
Windows® 10 IOT (64bit), Windows® 8.1 (64bit), Windows® Embedded 8 Standard (64bit),  
Windows® 7 (32 / 64bit), Windows® Embedded Sta 7 (32 / 64bit),  
Ubuntu 14.10 above, Fedora 25 above, Debian 8 above, CentOS 7.3 above,  
Mint 18.1 above