

VEHICLE AHD AI SOLUTION

AHD Camera
(Blind spot warning)



AHD Camera
(Blind spot warning)



AHD Camera
(Rearview)



AHD Camera
(Driving Assistance)



It is a rugged tablet with 4-channel AHD camera inputs for video surveillance and recording. It is specially designed for fields of fleet management, farm precision, forklift safety, heavy equipment in mining and construction industries, etc. This tablet integrates GPS, LTE, WIFI, and Bluetooth, providing users with mobile connectivity and real-time visibility of location. The high-definition AHD camera inputs offer you a full view of the side blind/ rear/ front/ cabin of the vehicle no matter day or night, improving safety and avoiding potential risks.

FEATURES



4-CH AHD Camera (optional)

Up to 4 channel AHD 720P camera inputs for video surveillance and recording



DMS & ADAS (optional)

Driver Monitoring System and Advanced Driver Assistance System offer you safer driving experience



High Brightness

1000 nits higher brightness display readable in the sunlight condition and outdoor environment



Real-time Precision Tracking

Dual-satellite system running GPS + GLONASS
Built-in 4G LTE for high precision positioning



ISO 7637-II

ISO7637-II standard transient voltage protection
withstand up to 174V 300ms car surge impact
DC9-36V wide voltage power supply design



Industrial-Grade Design

IP67 water and dust enclosure rating
1.2 meters drop resistance
US military anti-vibration & shock standard MIL-STD-810G



CAN BUS (optional)

CAN Bus interface with CAN 2.0B protocol provide a standard bus for automotive computer control systems and embedded industrial control local area networks



Mobile Device Management

Integrated with MDM management software to support device management, remote control mass deployment and upgrade etc.





It is an all-in-one solution with 4 CH AHD camera inputs and wireless functionality, ideal for vehicle tracking, asset management, data communication and storage to cloud servers. MDM software facilitates end-to-end fleet control, device management, which gives you the capability to access and manage your fleet anywhere remotely.

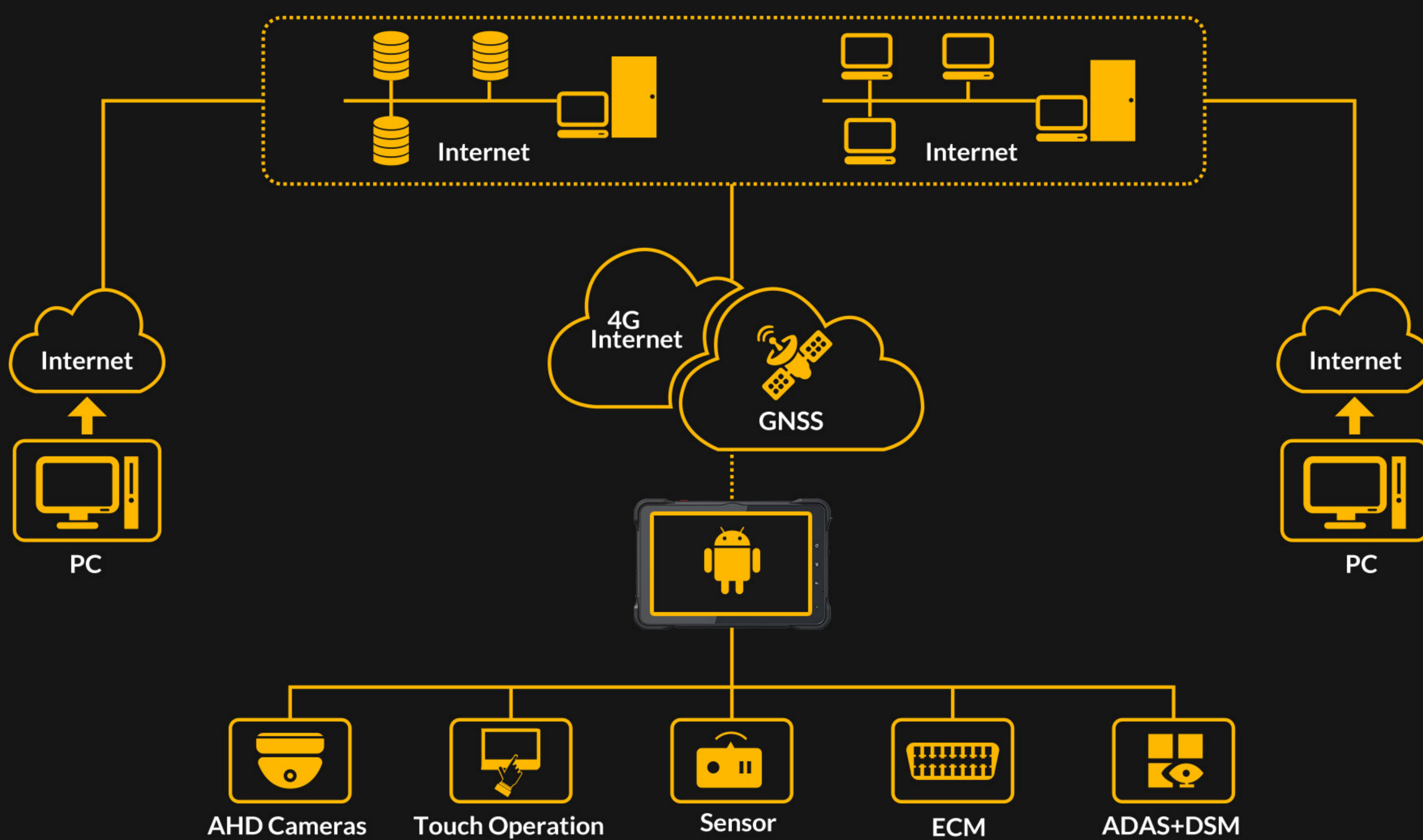

SPECIFICATIONS

System	CPU	Qualcomm Cortex-A53 64-bit Octa-core Processor, 1.8 GHz
	GPU	Adreno 506
	Operating System	Android 9.0
Storage	RAM	2 GB LPDDR3 / 4GB (optional)
	Flash	16 GB eMMC / 64GB (optional)
	Storage Expansion	Maximum Support Micro SD 512 GB
Display	LCD	10.1 inch HD (1280 x 800), 1000 cd/m ² Sunlight readable
	Touchscreen	Multi touch capacitive touchscreen
Digital Camera	Camera (optional)	Rear: 16 MP
Communication	Bluetooth	BLE 4.2
	WiFi	IEEE 802.11 a/b/g/n/ac; 2.4 GHz/ 5 GHz
	2G/3G/4G	LTE, HSPA+, UMTS, EDGE, GPRS, GSM (Data and Voice)
	GNSS	GPS/GLONASS
	NFC (optional)	Read/Write Mode: ISO/IEC 14443 A&B up to 848 kbit/s, FeliCa at 212 & 424 kbit/s MIFARE 1K, 4K, NFC Forum type 1, 2, 3, 4, 5 tags, ISO/IEC 15693 All peer-to-peer modes Card Emulation Mode(from host): NFC Forum T4T (ISO/IEC 14443 A&B) at 106 kbit/s; T3T FeliCa
AHD Video Input	Video Input	4 x 720P AHD Independent input 1.0Vp-p, 75Ω
	Video Standard Format	PAL format: 25 frames per second; NTSC format: 30 frames per second
AI Solution (optional)	ADAS (NEW)	Lane departure, Forward collision, Headway monitoring
	DMS (NEW)	Driver ID Management, Driver Abnormality
		Fatigue, Yawning, Camera Block, Mouth Block, Smoking, Distraction, Calling etc.
Audio	Built-in Microphone	x1
	Audio Output	Built-in 2W speaker
Video and Audio Compression	Video Encoding Format	H.265/H.264
	Video Format	TS/MP4
	Image Format (choose 1 of 2)	PAL: 4 x 720P NTSC: 4 x 720P
	Dual Stream	Support Dual stream
	Video Bit Rate	192Kbps-4096Kbps (Per channel)
Interface	Type-C	Compliant with USB 3.0 (for charging and data transfer; support OTG)
	Docking Connector	POGO PIN x24
	Headphones and Microphones (four-stage)	x1
Sensor	Gyroscope, Accelerometer, Light sensor, Compass	
Power Supply	DC Input	DC9-36V (ISO 7637-II compliant)
	Battery	3.7V, 8000mAh Li-ion (Replaceable)
Physical Dimensions (WxDxH)	277x185x31.6mm	
Weight	1357g	
Environmental Reliability	Drop Test	120cm
	Vibration Test	MIL-STD-810G
	Dustproof and Waterproof	IP67
	Operating Temperature	-10° C ~ 65° C (14°F-149°F) ; 0° C ~ 55° C(32°F-131°F) (Charging)
	Storage Temperature	-20° C ~70° C
Extended Interfaces	Connection	Docking Station
	USB2.0 (Type-A)	x1
	RS232	x1
	AHD (support ADAS, DMS)	x4 (with 12V power output each)
	ACC	x1
	Power	x1 (9-36V)
	GPIO	x2
	CANBUS	x1 (Optional)

Docking Station



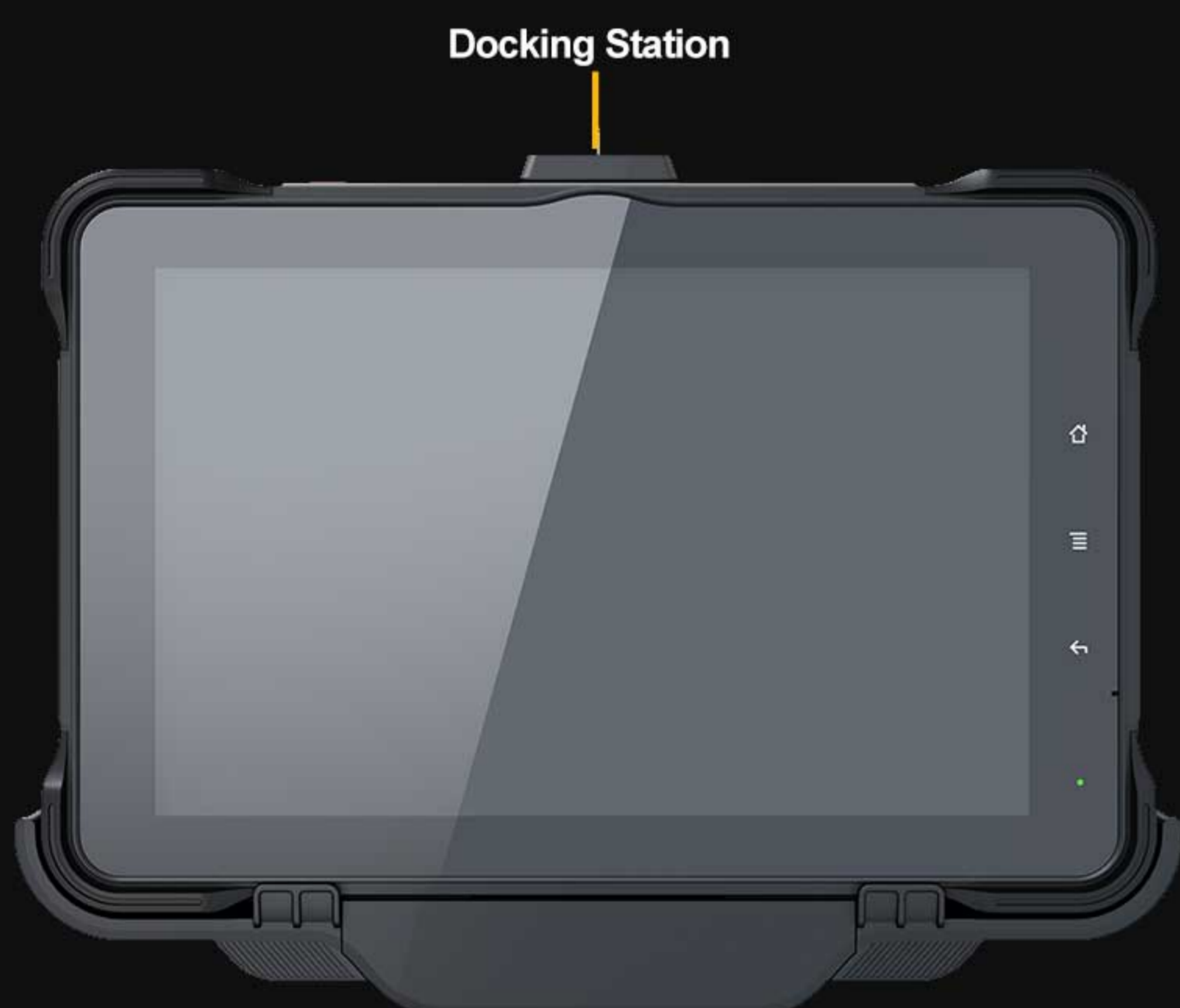
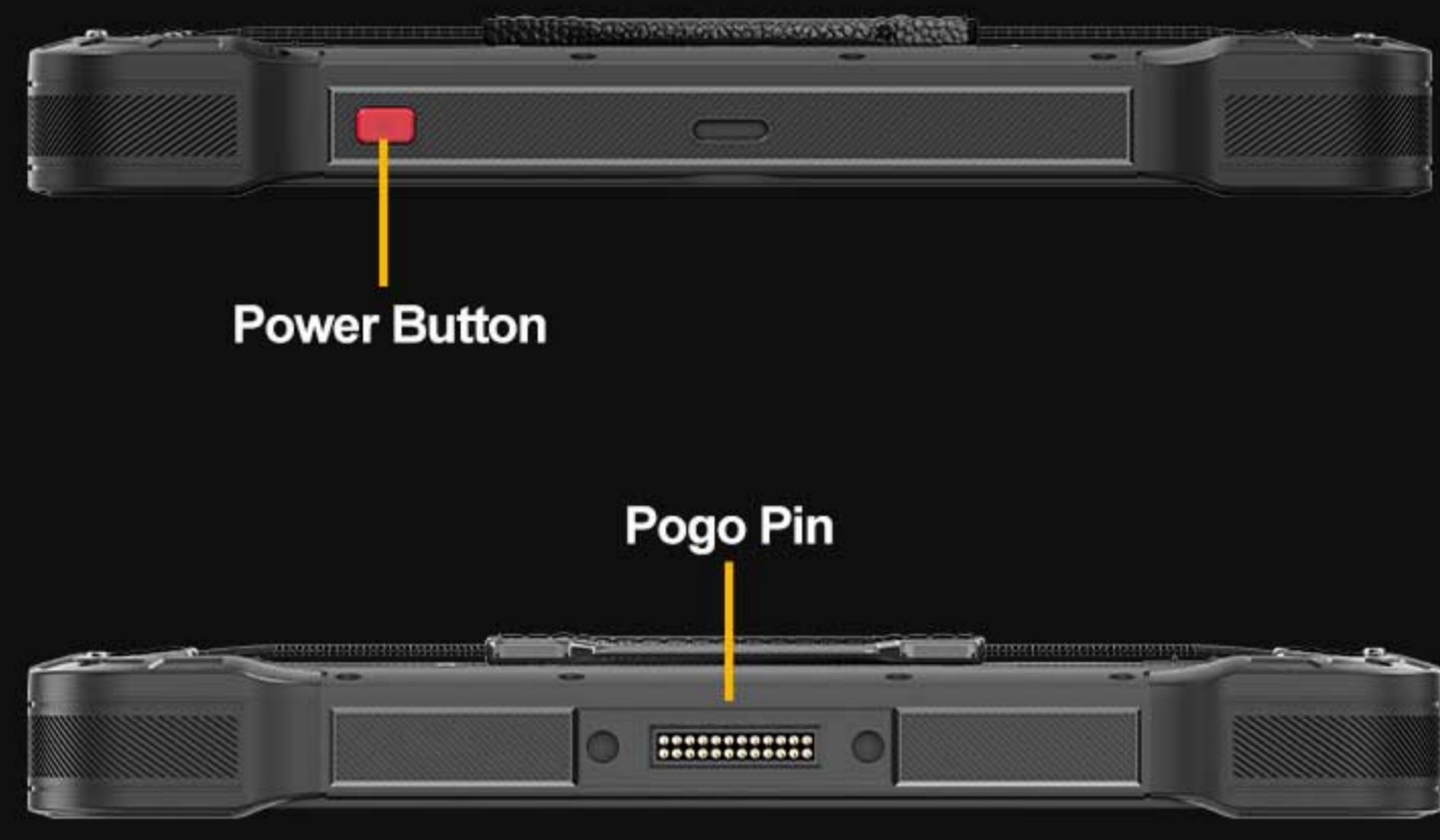
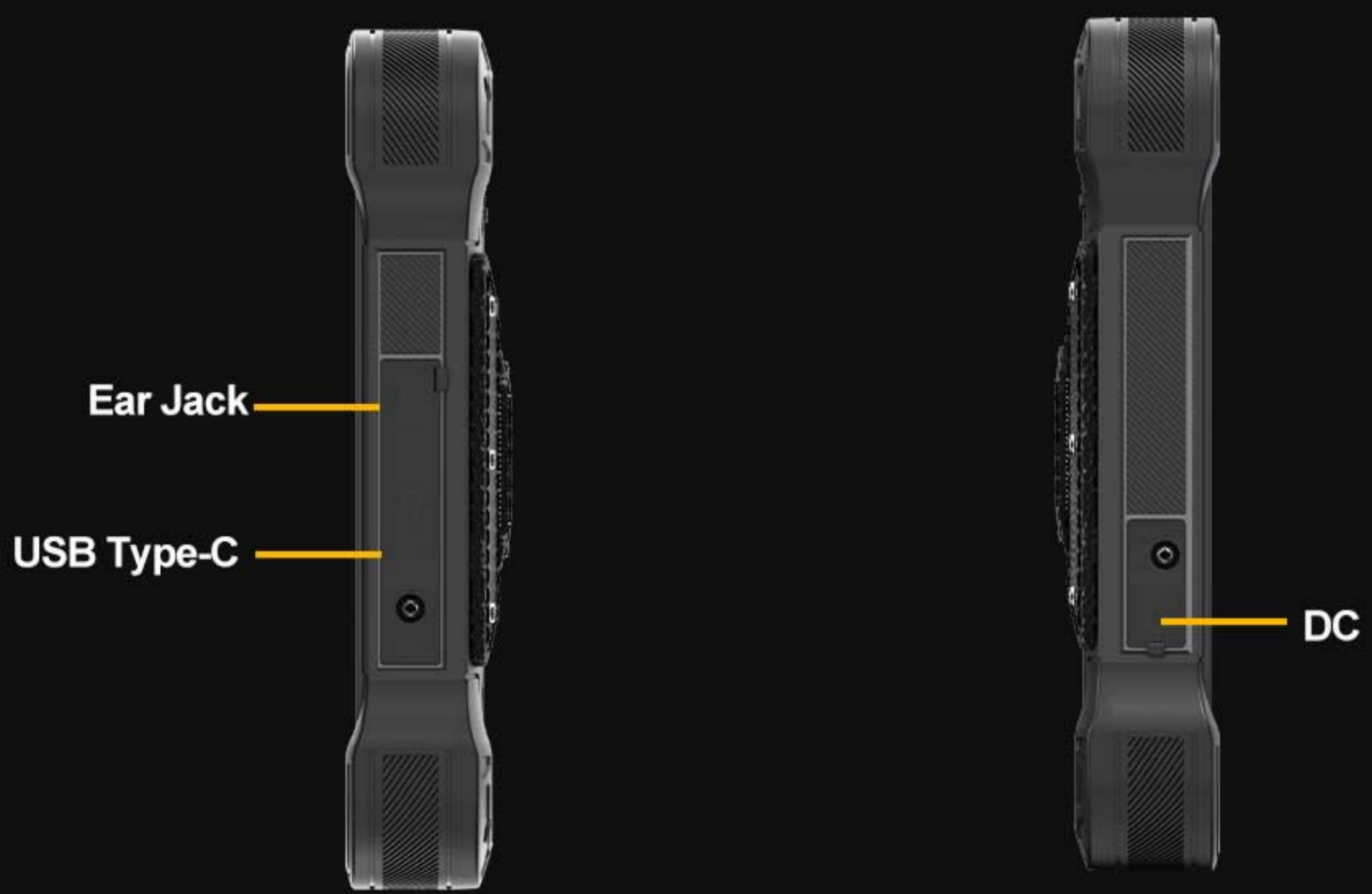
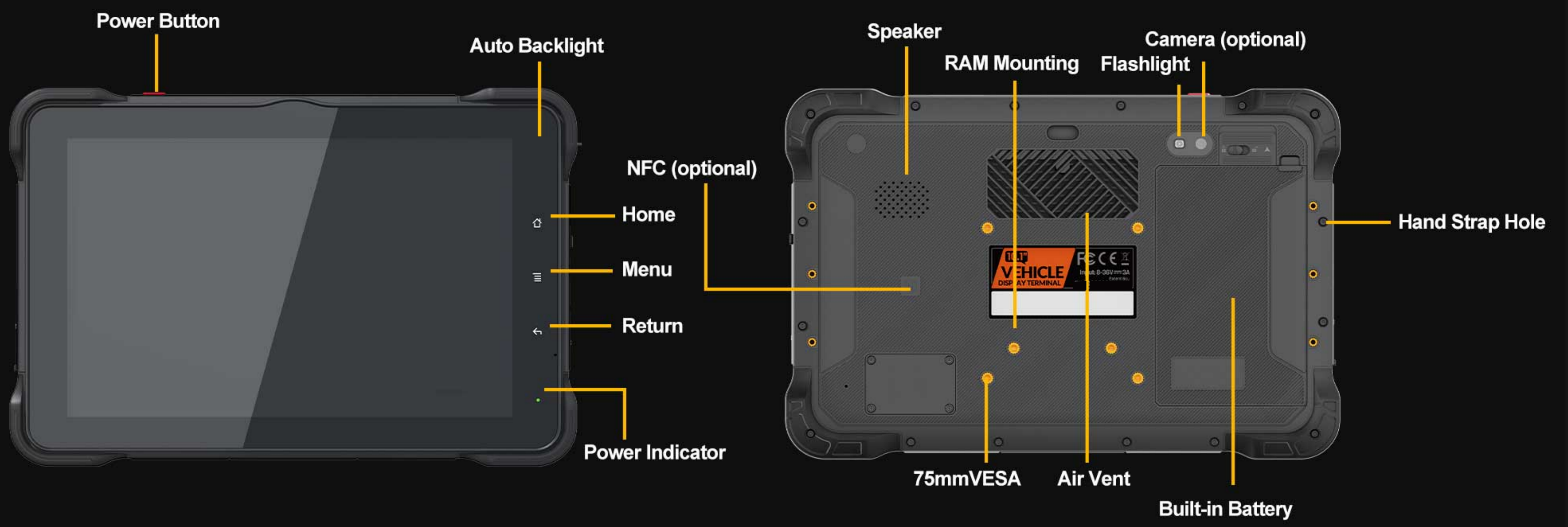

Accessories

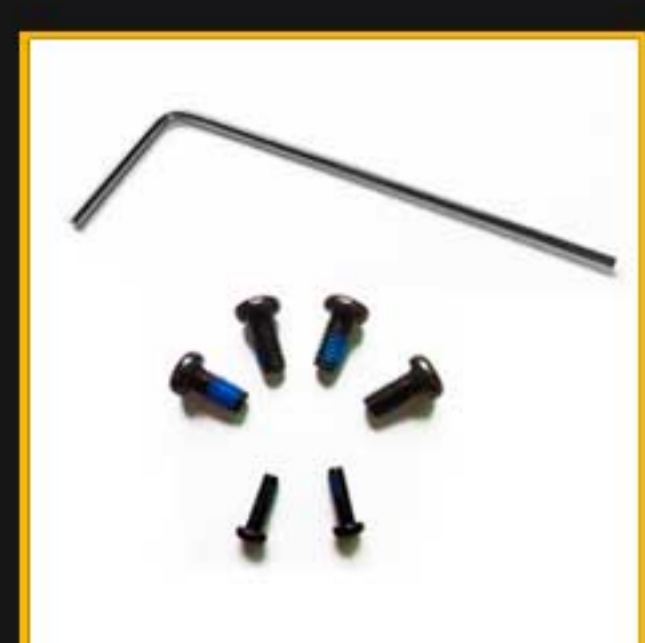

Allen wrench
Screws for RAM
SIM card plug



USB to Type-C cable



Power adaptor

Standard



Rear View AHD Camera
AHD-720R



ADAS Camera
AHD-1080ADAS



DMS Camera
AHD-720DMS



Side View AHD Camera
AHD-720S



Video Cable

Optional