

Q777

In-Vehicle Mobile Data Terminal Rugged Tablet



Android

Support Android 14

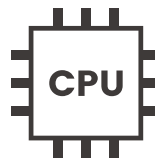

Processor

RK3568 64-bit Quad-Core A55, up to 2GHz, Mali-G52 800MHz, 4GB LPDDR4, 32GB eMMC



7" LCD panel

7-inch IPS 1280×800 LED backlight



Unlimited wireless connection

4G LTE, WiFi, BT 5.0, GPS/GLONASS/BEIDOU NFC

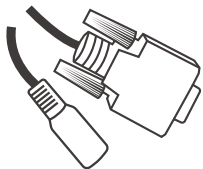

Multiple interface

RS232, RS422/R485, AHD camera in, USB Type-C, ACC, reverse gear trigger



Camera

2.0MP CMOS (front)
5.0MP CMOS (back)

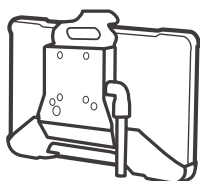

Ideal for driver

Portable design with vehicle docking station



Water/Dust-Proof

IP65 protection grade

TYPICAL APPLICATIONS



Public Transportation



Taxi Dispatch



Smart Mining



Forklift Safety



Fleet Management

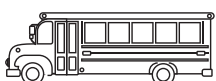

School bus



Waste & Recycling
Collections



Ambulance



Construction



Precision Agriculture

SPECIFICATION

Core	
Processor	RK3568 64-bit Quad-Core A55, up to 2GHz
GPU	Mali-G52 800MHz
NPU	Up to 1TOPS
RAM	4GB LPDDR4
ROM	32GB eMMC
OS	Android 14

Display	
LCD panel	7-inch IPS, LED backlight
Resolutions	1280 × 800
Brightness	350 cd/m ² (typical)
Contrast Ratio	800:1
View Angle (°)	85/85(L/R), 85/85(U/D)
Touch panel	Capacitive 5-point multi-touch screen P-CAP touch technology

Wireless	
WiFi	IEEE 802.11 a/b/g/n/ac 2.4GHz & 5GHz
Bluetooth	Support Bluetooth 5.0 BLE
Cellular	4G
Positioning	Support GPS/GLONASS/BEIDOU External GPS receiver/antenna(option)

Optional Function	
Camera	2.0MP CMOS (front) 5.0MP CMOS (back)
NFC	ISO/IEC 14443 A&B, MiFare® 1K/4K, FeliCa, NFC Forum Type 1-5, ISO/IEC 15693
RTC	Built-in
MIC	Internal microphone
Light sensor	Built-in
Compass	Built-in
Gyroscope	Built-in
Speaker	speaker 1.5W

Multimedia	
Video	Decode: 4K@60fps H.264&H.265&VP9 Profile0/2 video decode, 1080P multi-video decode. Encode: 1080P video encoding for H.264 and H.265
Audio	MP3, WMA, OGG, APE, FLAC, AAC etc.

User Interface	
Onboard I/O ports	1 x TF card slot(up to 128GB) 1 x SIM card slot 1 x USB Type-C 1 x Combo Audio Jack (audio+mic) 1 x POGO PIN (20 PIN)
Extended I/O ports (on pigtail cable)	1 x ACC Input 1 x Reverse Gear Trigger 1 x RS232 1 x RS422 (RS485 optional) 1 x AHD Camera In 1 x DC in (9~36V)
Function Key	Power, Menu, Home, Return
Power light	Red(charging), Green(full)

Power Supply	
DC In	12V DC (9~36V)
Battery	3.7V 5000mAh, Lithium-Polymer battery pack (run-time up to 3 hours)

Power Consumption	
Normal mode	≤9W
Charging mode	≤12.5W

Environment	
Operating Temp	-20°C~70°C (w/o battery) -10°C~50°C (w/ battery)
Storage Temp	-20°C~80°C
IP Rating	IP65
Compliance	FCC, CE, ISO7637-2, ISO10605, ISO16750-2

Mechanical	
Dimensions	198(L) x 130(W) x 20(H) mm
Weight	465g
Mount	VESA, RAM, Double-T compliant

Accessories	
Standard	AC/DC adaptor or car power adaptor(optional) Docking station with cables
Optional	External GPS receiver/antenna AHD Camera 720P/1080P

INTERFACE

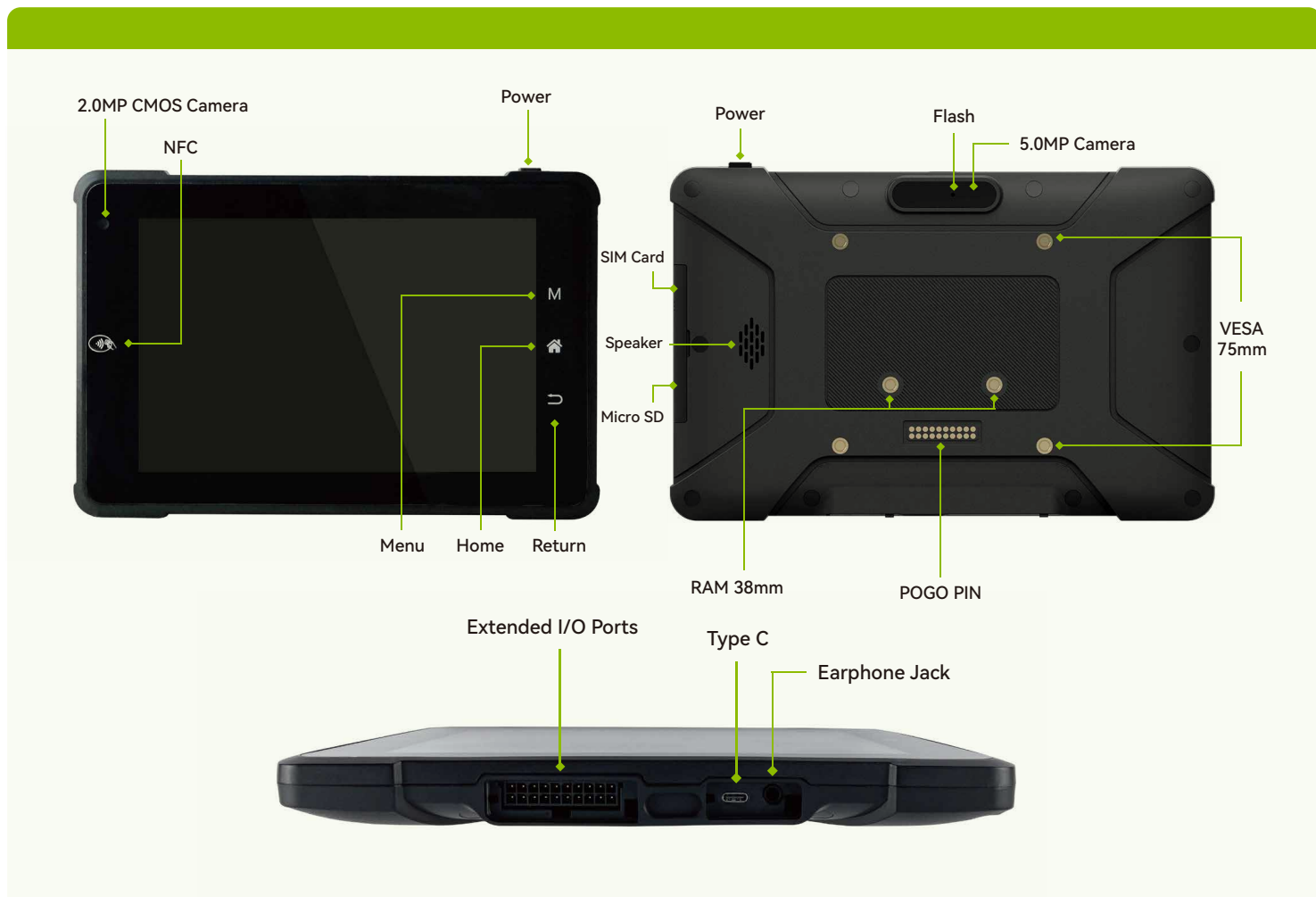

ACCESSORIES

Docking Station

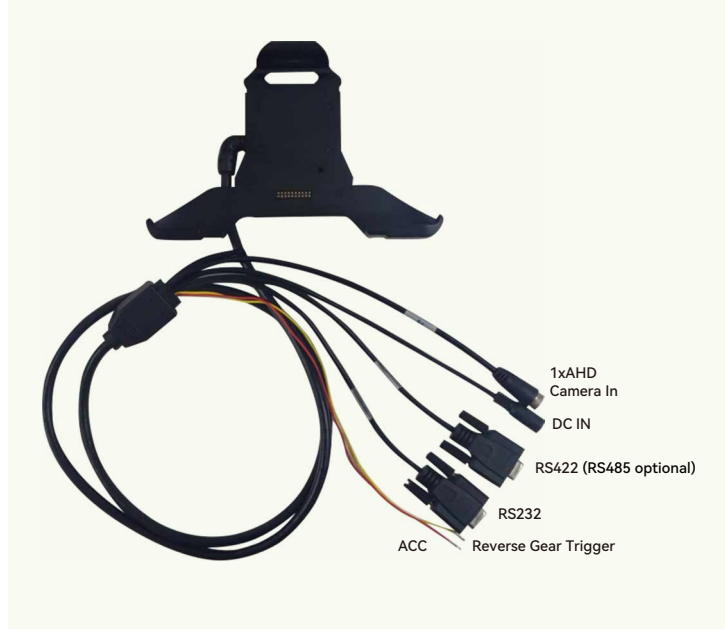

AHD Camera 720P/1080P



Gmouse



AC/DC Adaptor

